

PROPOSED ---- SURPRISE – CHURCH OF CHRIST – 14925 W. Silverleaf Way, Surprise, AZ 85374

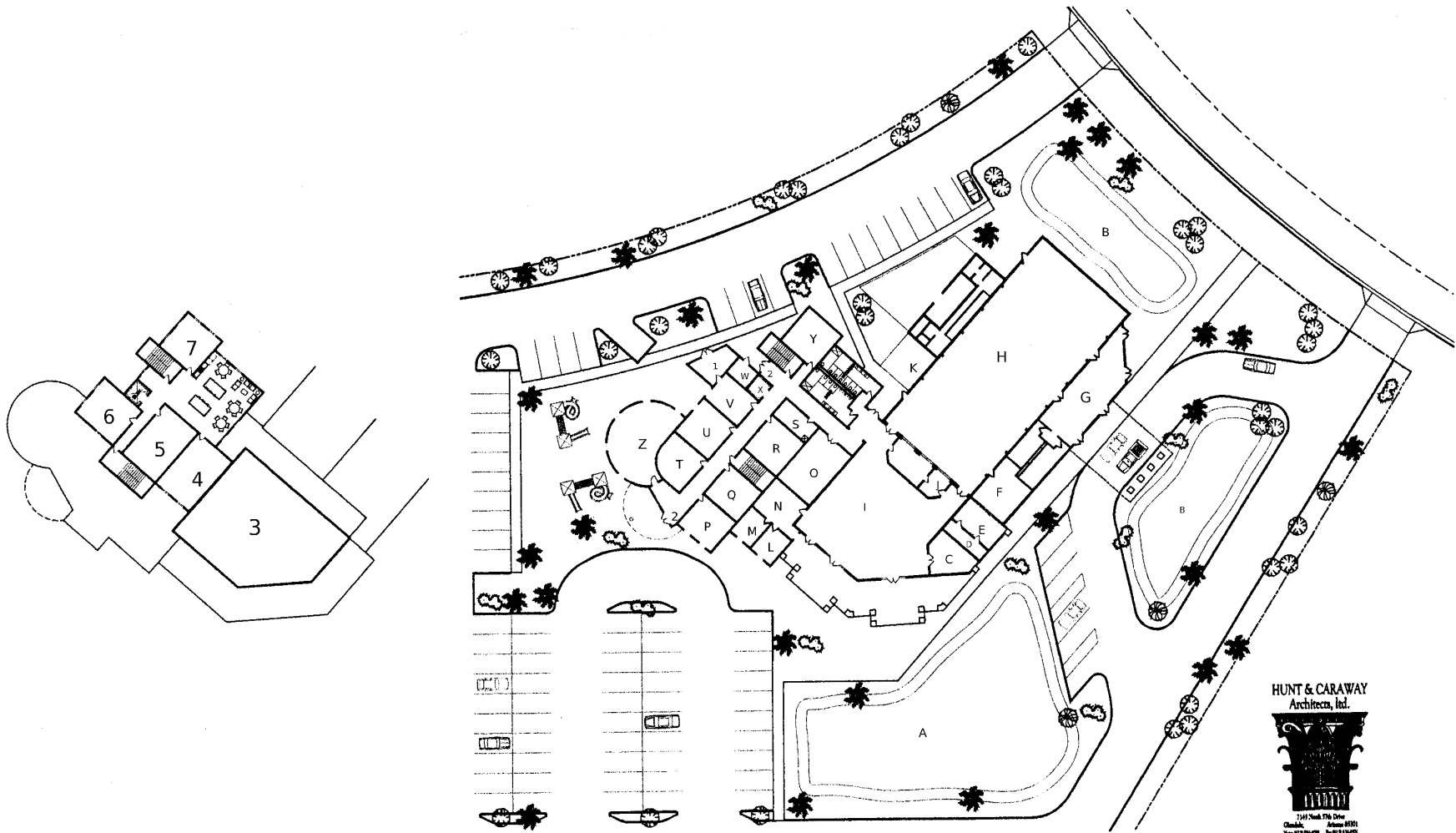

**HUNT & CARAWAY**  
Architects, Ltd.  
1411 North 7th Drive  
Chandler, Arizona 85225  
Van Buren Street, Suite 101 Phoenix  
San Francisco 94101



**SITE PLAN - TWO STORY - PHASE 2**

SCALE 1" = 20'  
 PHASE 1 - 8,489 SQ. FT. (INCL. COVERED PATIO)  
 PHASE 2 - 7,419 SQ. FT. FIRST FLOOR  
 PHASE 3 - 4,198 SQ. FT. SECOND FLOOR

PROPOSED ---- SURPRISE – CHURCH OF CHRIST – 14925 W. Silverleaf Way, Surprise, AZ 85374

LEGEND: Tentative plans that may be changed

A	Yard
B	Yard
C	Storage
D	Pantry
E	Kitchen extension
F	Existing Kitchen
G	Lobby
H	Existing Worship Area
I	Fellowship – 50' X 63'
J	Cry Room
K	Mech. Yard
L	Office
M	Office
N	General Office
O	Conference Room 20' X 20'
P	Grade 3-4 10' X 20'
Q	Grade 1-2 18' X 20'
R	Toddlers 20' X 20'
S	Janitor Storage
T	Pre-school 20' X 20'
U	Grade 5-6 20' X 20'
V	Education Work Room 15' X 20'
W	Elev. Equip
X	Elev.
Y	Cradle Roll
Z	Children's Learning Time 20' X 30'
1	Storage room
2	Exit
4	Adult Classroom 20' X 30'
5	Adult Classroom 20' X 30'
6	Grade 7-8 23' X 20'
7	Teens 20' X 20'